

NV Series

Unidirectional seal Knife Gate Valve with open body and multipart seat



- Model:** NV
- Working pressure:** DN50-DN100/2"-4" 16bar
DN125-DN200/5"-8" 10bar
DN250-DN400/10"-16" 7bar
DN600-DN700/24"-28" 3bar
DN800-DN900/32"-36" 2bar
DN1000-DN1400/40"-56" 1bar
- Type:** Wafer, Lug, Flange
- Design Standard:** MSS SP-81
- Flange Standard:** DIN EN 1092 / ANSI B16.5 / others
- Face to Face:** MSS SP-81 / customer specification
- Testing Standard:** DIN EN 12266 / API-598
- Operation:** handwheel, electric, pneumatic, hydraulic, sprocket, electro-hydraulic, gear
- Body material:** F55, F53, CF3M, CF8M, CF8, WCB, GGG40, customer specification
- Wedge material:** SS310, CF3M, CF3, CF8M, CF8 WCB, GGG40, F55, F53, 2205, SS310, SS316L, SS316, SS304, customer specification
- Sealing material:** NBR, EPDM, FKM, PTFE, other materials upon request
- Packing:** PTFE, EPDM
- Application areas:** Applicable in power plants, pharmaceuticals industry, petrochemical industry, food industry, paper-and-pulp industry.
- Applicable media:** Coal, slag discharge, sewage, water, oil, steam, grout, gold powder, ores, pulp, wood pulp, tailings, fibers, dust, chemicals, drain from sedimentation tanks, asphalt, bunker waste, fruit juices, cereals, slaughter plant waste and other media.

Features:

- Multipart seat improves the sealing performance
- Increased seat life

Product Description:

NV Series Knife gate valve construction includes a replaceable knife gate, its sealing principle is realized by a close connection between the gate and the rubber seals. Its main characteristic is that the elastomer sealing ring is set in the seat groove and is locked by the metal seat, which holds the elastomer seal during opening and closing of the valve. The stainless steel seat ring prevents the seal ring from falling off and prolongs the service life. Therefore, this valve is cost-efficient.

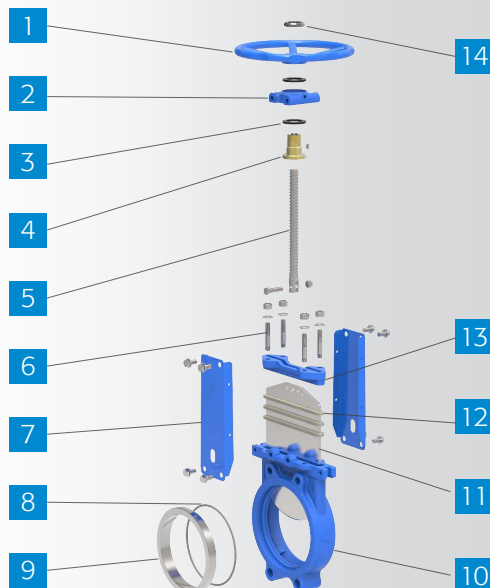

| Code | Name | Material | QTY |
|------|---------------|---------------------------------|-----|
| 1 | Hand wheel | Steel | 1 |
| 2 | Yoke Cap | Steel | 1 |
| 3 | Bearing | GCr15 | 2 |
| 4 | Stem Nut | Brass | 1 |
| 5 | Stem | Stainless steel | 1 |
| 6 | Bolt & Nut | Stainless steel | N |
| 7 | Yoke | Steel | 2 |
| 8 | Seat | EPDM/NBR/FKM/PTFE | 1 |
| 9 | Seat Gland | 2Cr13/SS304/SS316 | 1 |
| 10 | Body | F55/F53/CF3M/CF8M/CF8/WCB/GGG40 | 1 |
| 11 | Disc | F55/F53/SS304/SS316/2205 | 1 |
| 12 | Packing | PTFE/EPDM | 3-5 |
| 13 | Packing Gland | CF8M/CF8/WCB/GGG40 | 1 |
| 14 | Stop Nut | Q235/SS304 | 1 |

